

Zeitschrift: Jahrbuch der Sekundarlehrerkonferenz des Kantons Zürich
Band: - (1916)

Artikel: Lehrgang für das geometrisch-techn. Zeichnen an Sekundarschulen und verwandten Lehranstalten
Kapitel: [Tafeln]
Autor: Sulzer, Heinrich
DOI: <https://doi.org/10.5169/seals-819669>

Nutzungsbedingungen

Die ETH-Bibliothek ist die Anbieterin der digitalisierten Zeitschriften. Sie besitzt keine Urheberrechte an den Zeitschriften und ist nicht verantwortlich für deren Inhalte. Die Rechte liegen in der Regel bei den Herausgebern beziehungsweise den externen Rechteinhabern. [Siehe Rechtliche Hinweise.](#)

Conditions d'utilisation

L'ETH Library est le fournisseur des revues numérisées. Elle ne détient aucun droit d'auteur sur les revues et n'est pas responsable de leur contenu. En règle générale, les droits sont détenus par les éditeurs ou les détenteurs de droits externes. [Voir Informations légales.](#)

Terms of use

The ETH Library is the provider of the digitised journals. It does not own any copyrights to the journals and is not responsible for their content. The rights usually lie with the publishers or the external rights holders. [See Legal notice.](#)

Download PDF: 22.11.2024

ETH-Bibliothek Zürich, E-Periodica, <https://www.e-periodica.ch>

FIG. 18.

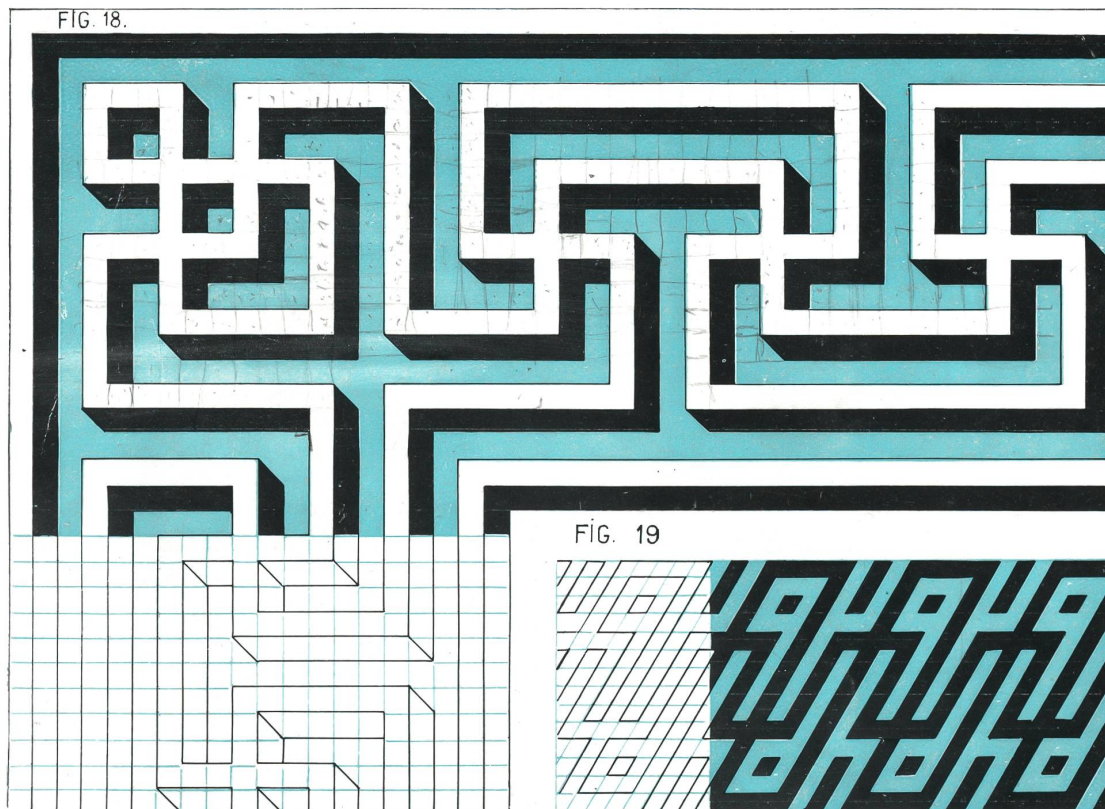
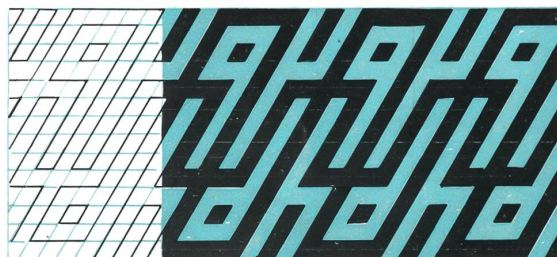
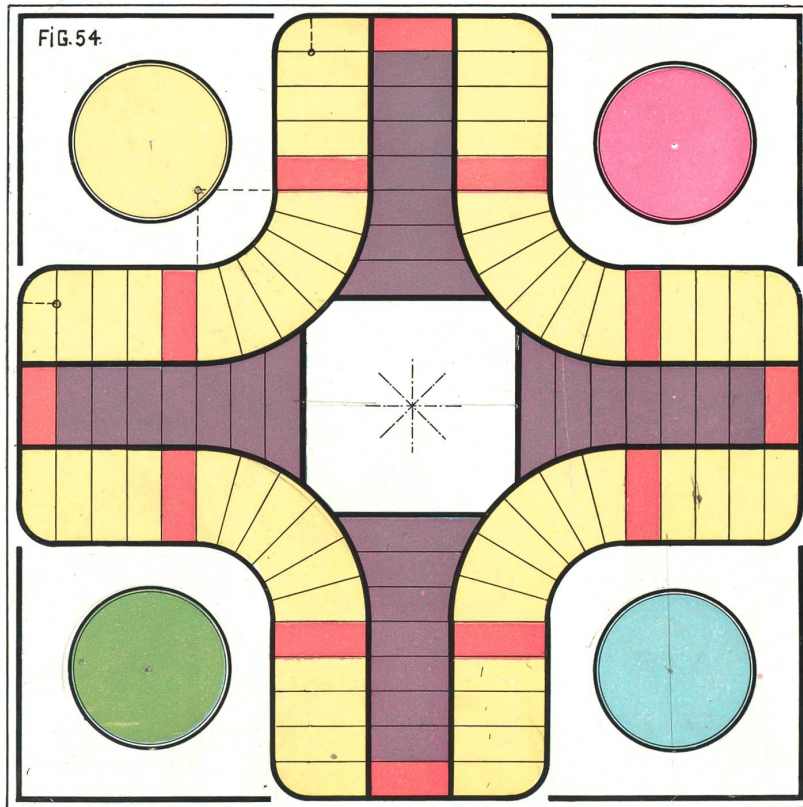
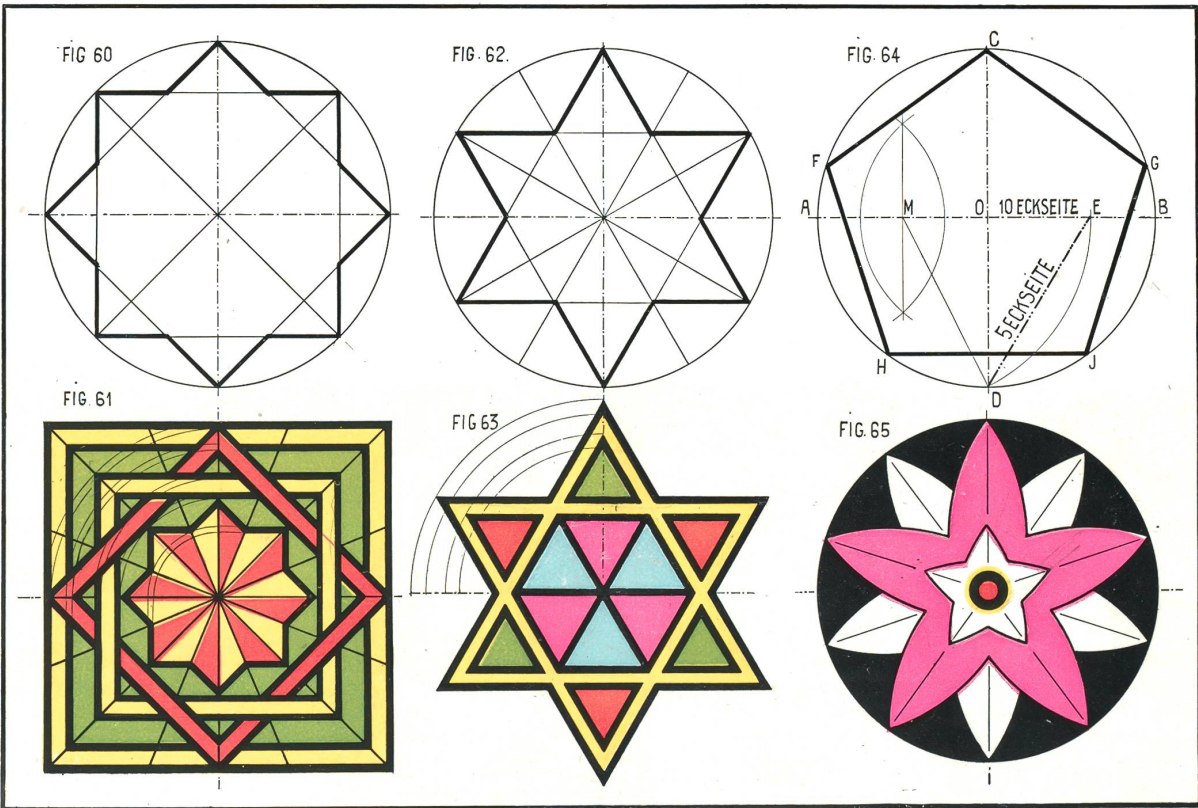
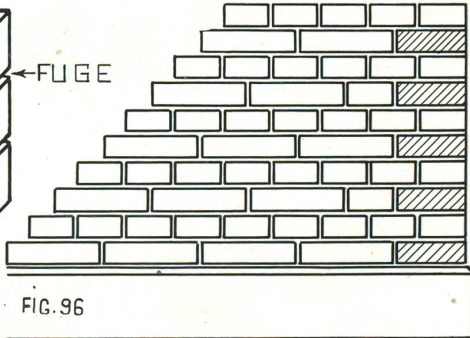
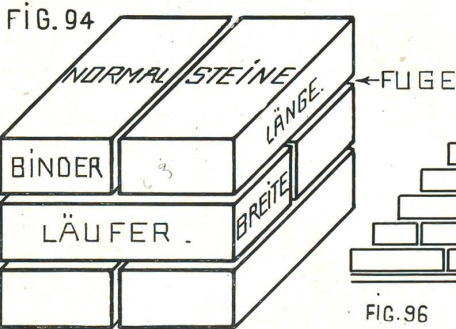
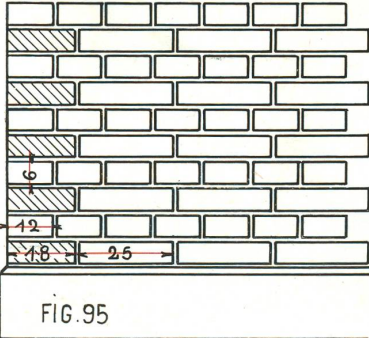
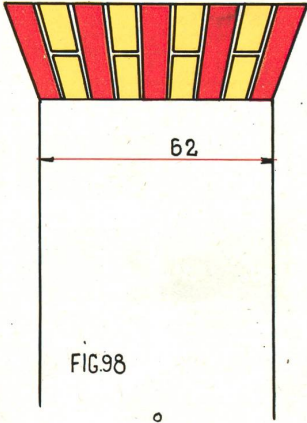
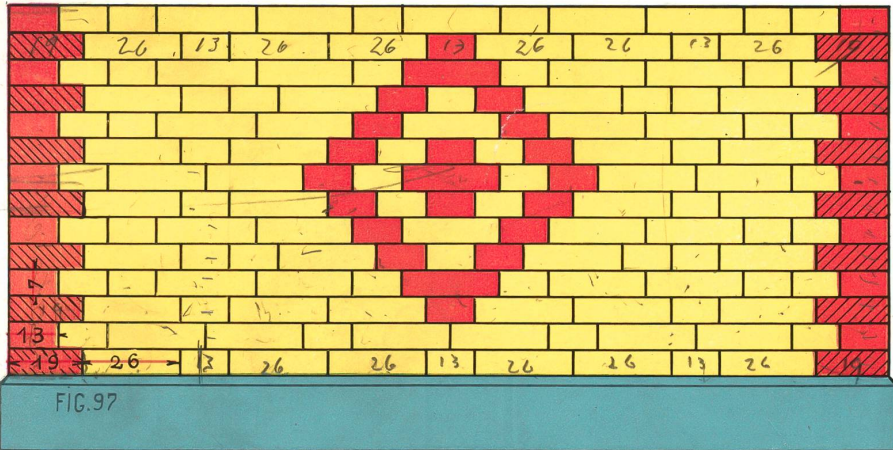

FIG. 19









NIETEN.I.

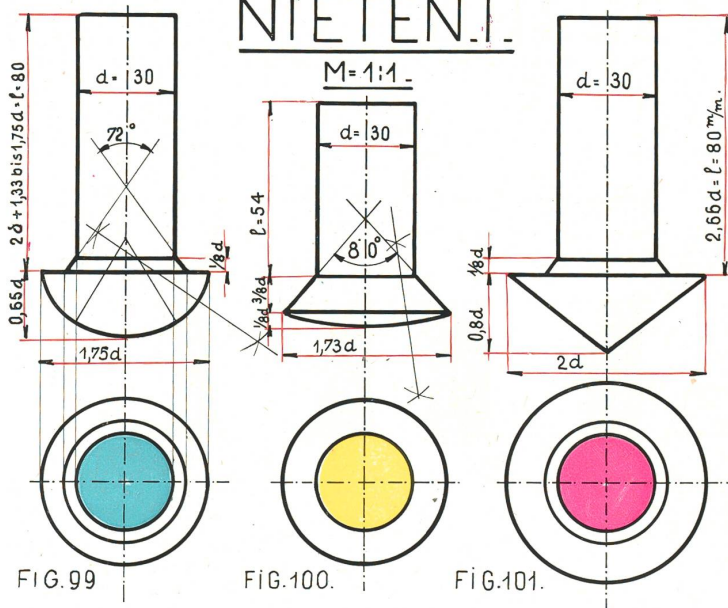

FIG. 99

FIG. 100.

FIG. 101.

C. MASCHINENZEICHNEN.

NEUTRALTON	Pr. BLAU mit TUSCH	VIOLETT	ZINNOBER	GELBROT	ROTGELB
GUSSEIS.	SCHMIEDEIS.	STAHL	KUPFER	BRONZE	MESSING

TECHN. FARBEN.

A. PLANZEICHNEN.

GRAUGRÜN	GRÜN	SEPIA
WALD.	WIESEN	ÄCKER.
HELLVIOLETT.	DKL. VIOLETT	Pr. BLAU
REBEN	GEMÜSELAND	WASSER
CARMIN	SIENA	OCKER
GEBÄUDE		WEGE

B. BAUZEICHNEN.

BLAUGRAU	CARMIN	CARMIN mit SIENA
BETON	HAUSTEIN	BACKSTEIN
GEBR. SIENA	OCKER u. GUMMIGT.	SEPIA
HARTHOLZ	WEICHHOLZ	ERDE
HELLGRAU	BRAUN	DKL. GRÜN
WEISSMETALL	LEDER. KAUT.	GLAS

HÜLSEN.

ANSICHT.

FIG. 104

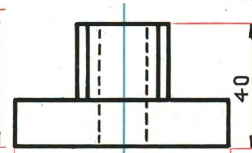
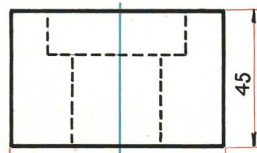
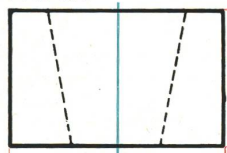
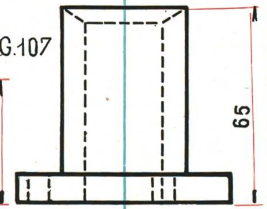

FIG. 107



SCHNITT.

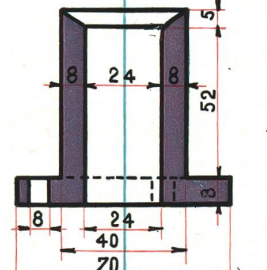
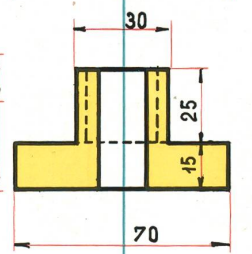
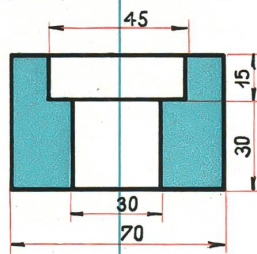
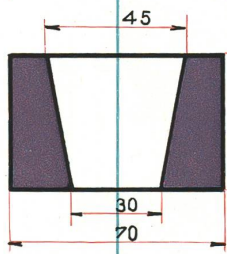
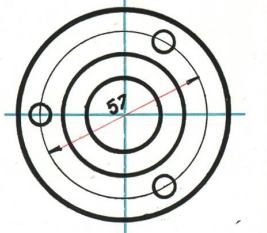
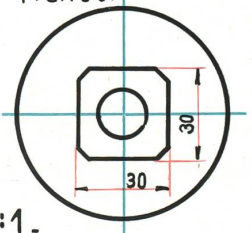
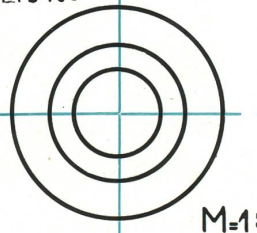
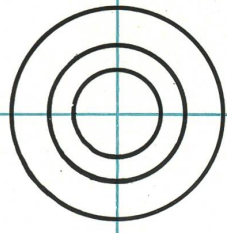

FIG. 105

FIG. 106.

DRAUFSICHT.



M=1:1.

FIG. 130.

PLAN DES SCHULGARTENS.

<i>Inhalte. m²</i>	
18 BEETE	
À 1,5.3,4	91,8
10 BEETE	
À 1,4.2,65	37,1
1 BEET 14,65	99,1
RANDBEETE	
31,2.0,5	156
WIESE & TEICH	
9.5,3	468
TOTAL	2004
WEGE	1566
GESAMT:	
INHALT 357.	

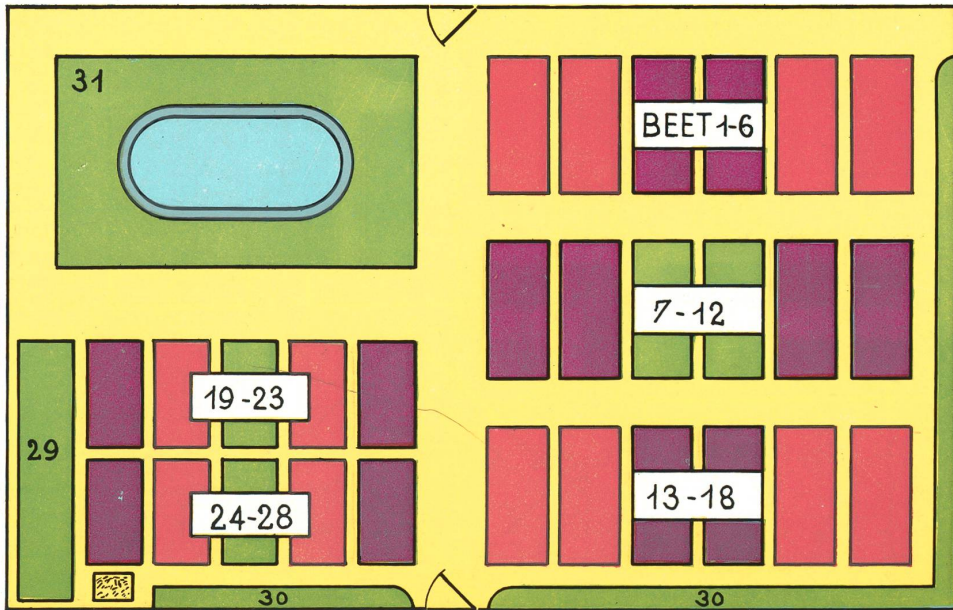

M=1:100.

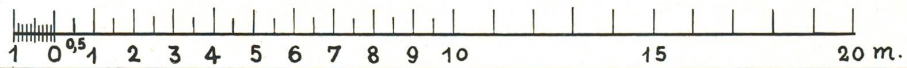

PROJEKTIONEN.1.

FIG. 132

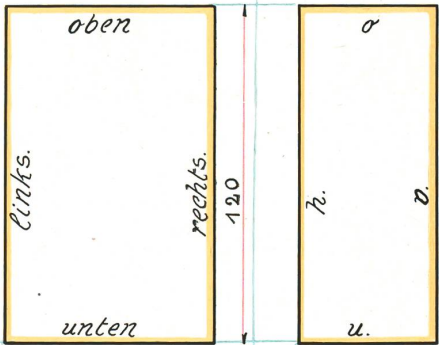

M=1:1

Inhalte.
 Oberfläche:
 $2 \cdot [5 \cdot 7,5 + 12(5+7,5)] =$
 375 cm^2
 Volumen:
 $5 \cdot 7,5 \cdot 12 =$
 450 cm^3

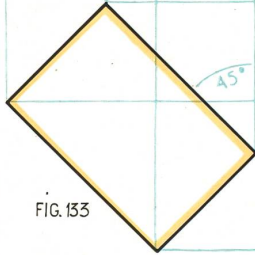
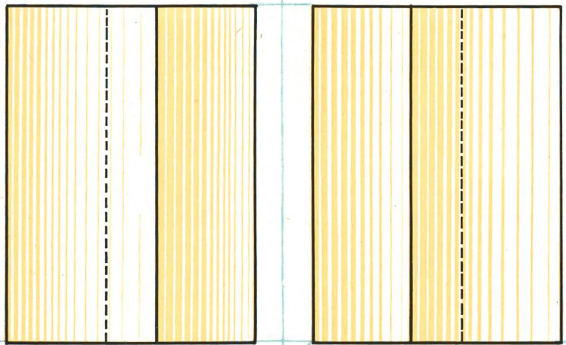

FIG. 133

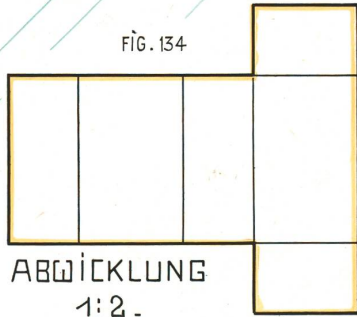

FIG. 134

ABWICKLUNG
1:2

HERBEL.

FIG. 162.

M=1:1

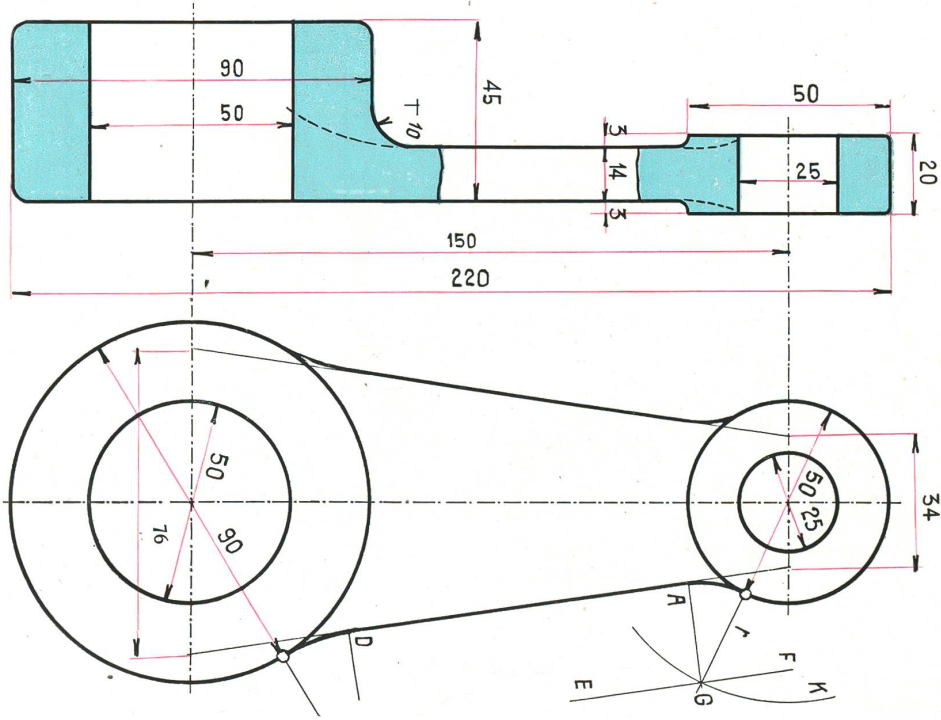

COORDINATENTAFEL.

Nr.	Abscissen.	Ordinaten.
1	26.	- 32.
2	17.	- 27.
3	- 8,25	- 16. 27.
4	A 0.	- 10,6 27. 37,5
5	+ 23,5	+ 21,8
6	35.	+ 28. 46,5
7	48,2	+ 10. 15. 35. 46,5
8	48,2	+ 40.
9	72,9	+ 42. 46,5
10	72,9	- 38,7
11	86,9	+ 22,5 46,5
12	105,4	- 37.
13	132,2	- 26,5 31,5

Industrieland in Zürich 3.

M=1:500.~

FIG.168.

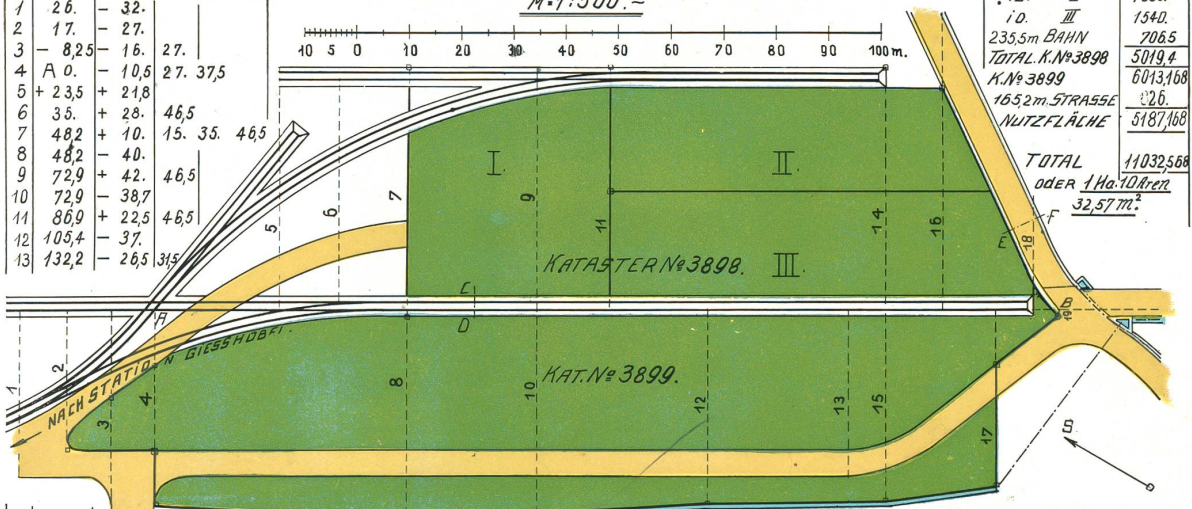

INHALTE. m²

PARZELLE I	14179
id. II	1355.
id. III	1540.
235,5m BAHN	7065
TOTAL K.N° 3898	5019,4
K.N° 3899	6013,168
165,2m STRASSE	226.
NUTZFLÄCHE	5187,168
TOTAL	11032,568
oder 1 Ha. 10 Ar. 22	
	32,57 m ²

14	+138,93	+ 22,5	46,5
15	138,93	- 35,2	
16	150	+ 42,5	56.
17	161,1	- 10.	33,5
18	167,4	+ 4,5	20,05
B	172	-	0,12

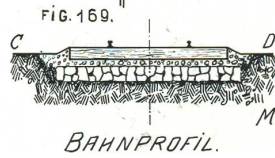

Zufgenommen von einer III. Sektklasse des Schulhauses Bühl B. Zürich 3. Sommer 1913.

FIG. 171.

PLAN
ZUM
EINFAMILIEN
HAUS.

M=1:100.

FLÄCHEN=
JNHALTE.

GEBÄUDE 119,17

HOF 153,25

GARTEN 161,85

TOTAL, m² 424,27

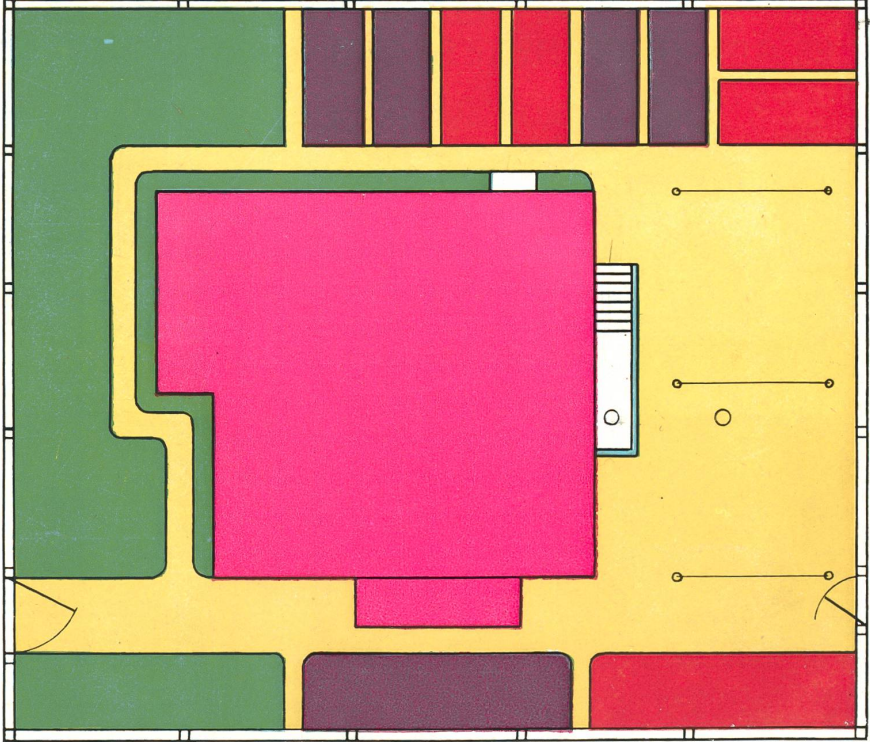
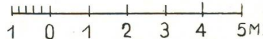

EINFAMILIENHAUS.

FIG.172. KELLERGRUNDRISS.

FIG.173. ERDGESCHOSSGRUNDRISS.

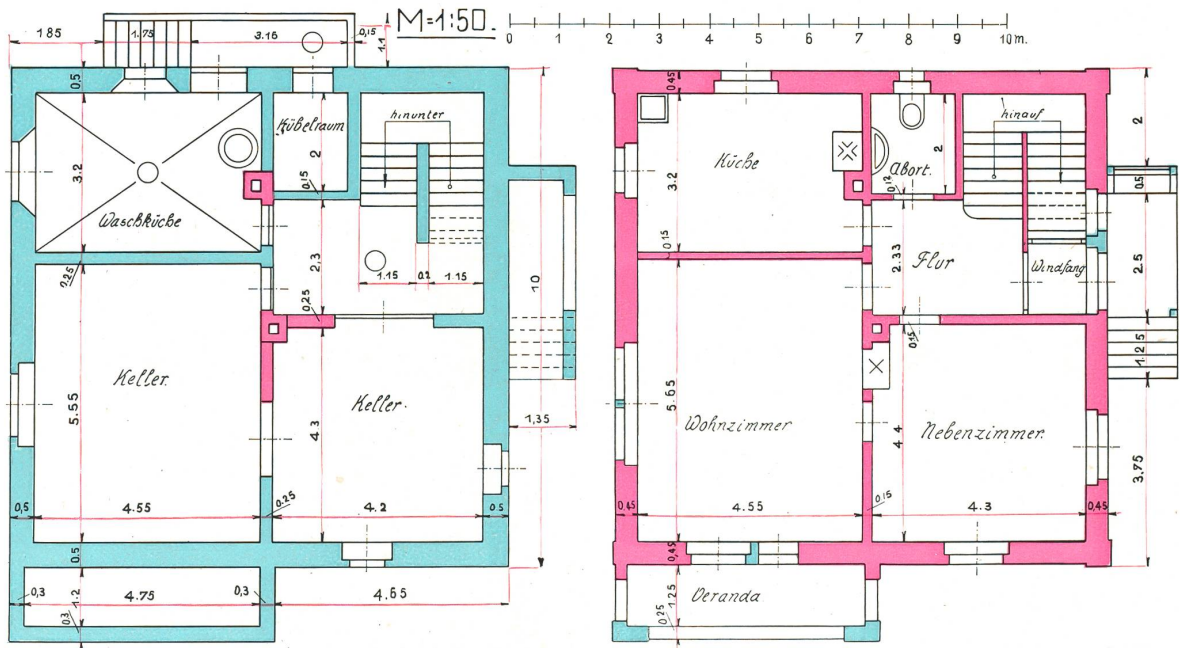

LAGERBÜCHSE.

M 1:1.

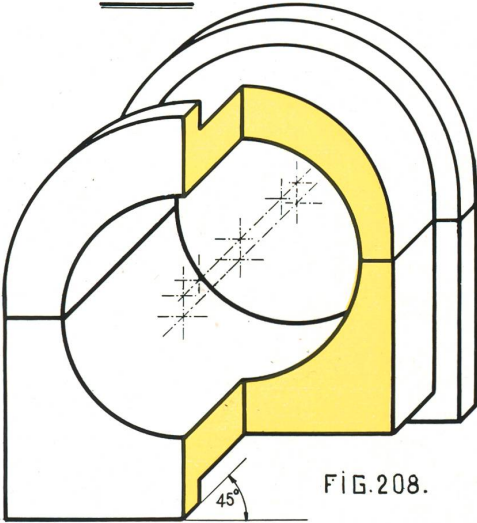
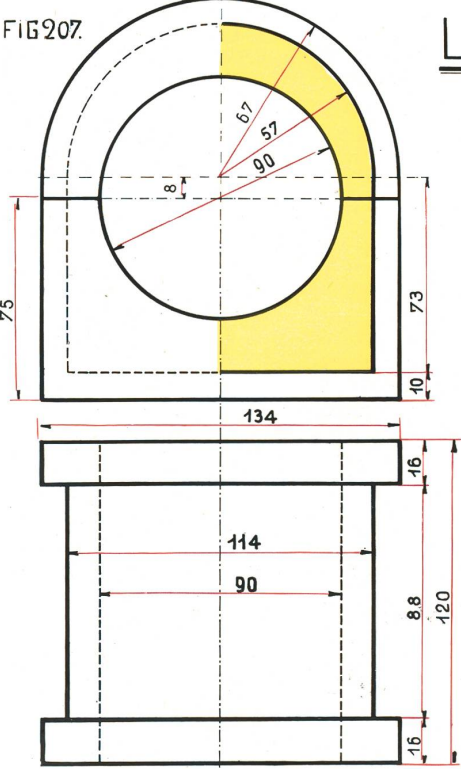

HORIZONTALE u. VERTIKALE MASSE 1:1, SCHRÄGE 1:2.

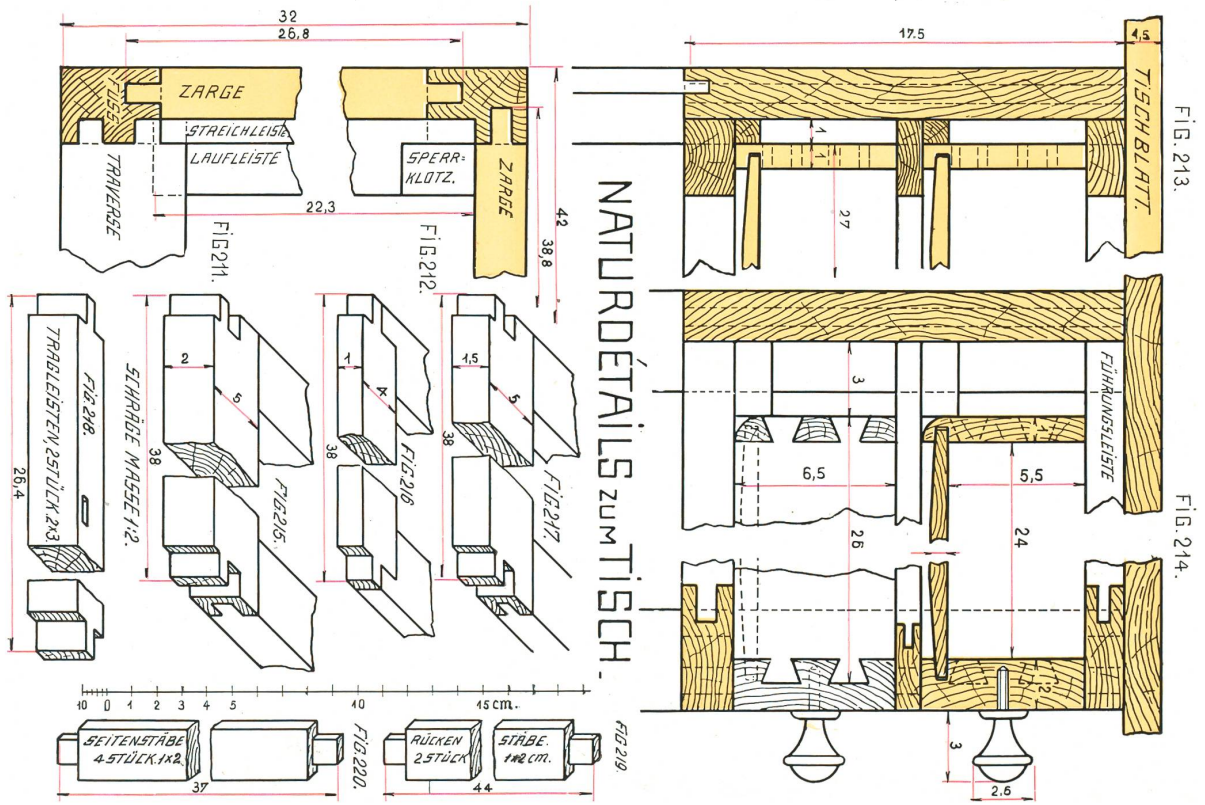

TEMPERATURKURVEN

FÜR LUGANO, ALTORF, ZÜRICH u. SÄNTIS.

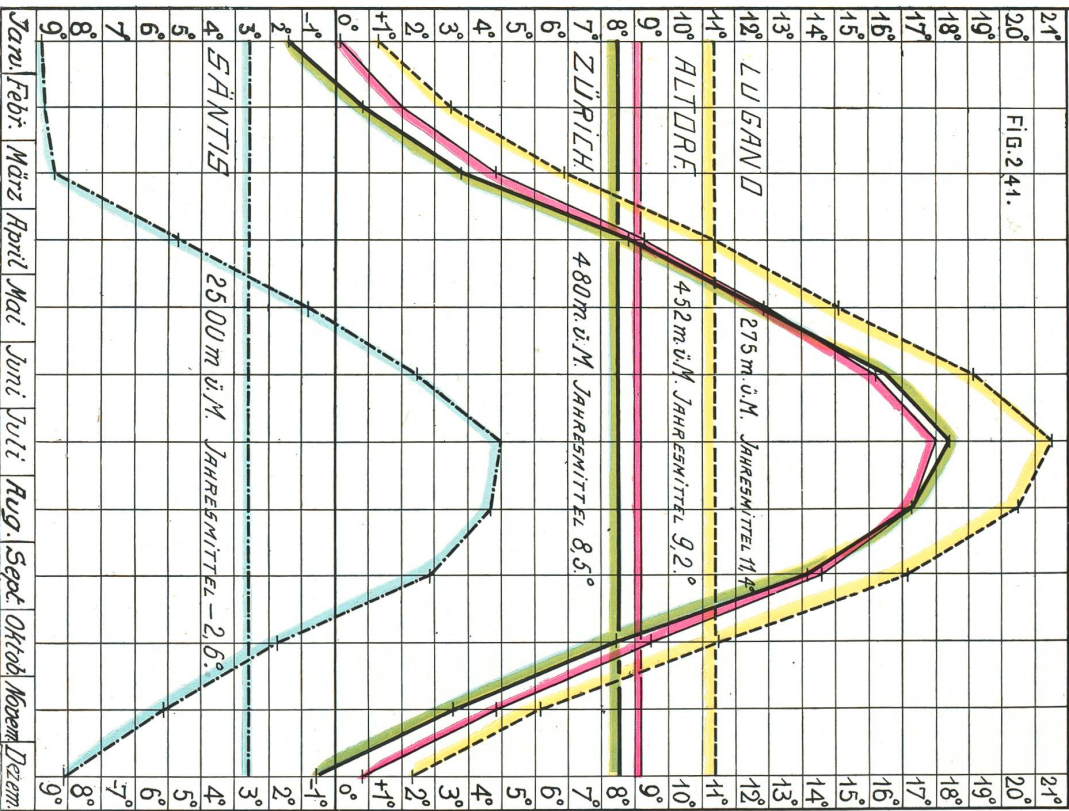

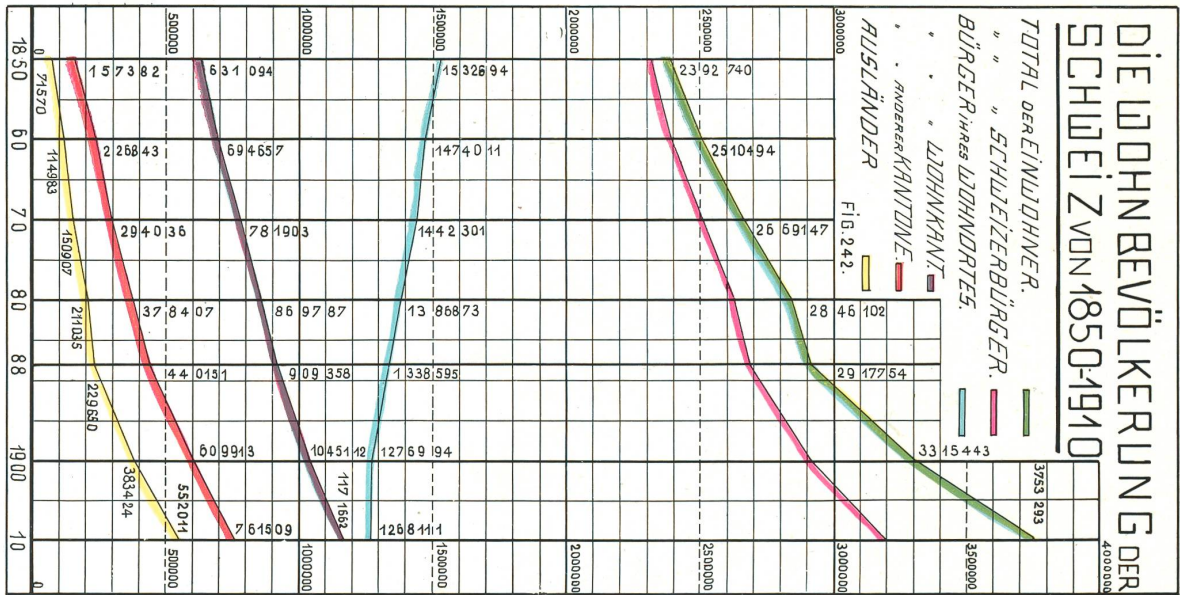

AUSLÄNDER.

1850. ZUNAHME 67,3%
 1910. FIG. 243.

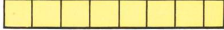

UDORNKANTON.
 1850.

FIG. 244.

SCHWEIZERBÜRGER.
 1910.
 ABNAHME 11,2%.

SCHWEIZERBÜRGER.
 1850. 1910.
 ZUNAHME 37,8%.

FIG. 245

EINWOHNER.
 1850 1910.

ZUNAHME 57,3%.

FIG. 246.

**Illustrations- und Farbendruck
von J. Gremminger & Co.
Buchdruckerel Töss**